



ELECBRAKES ANDROID AUTO USER MANUAL

App Version: V2.2.8

V1 12/04/2024

WHAT IS ANDROID AUTO?

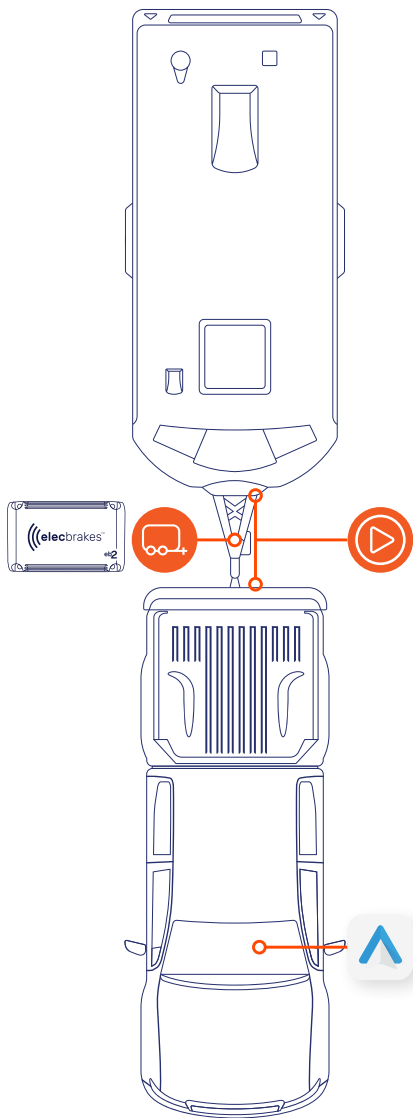

Overview

Android Auto is a feature developed by Google that allows a car radio or head unit to display and control an Android phone. The Elecbrakes app on Android Auto is compatible with all Android devices running Android 10.0 or later. Through Android Auto, users can interact with their device's content and functions such as Google Maps navigation, phone calls, text messages, and music, directly from the car's built-in display or via voice commands through Google Assistant.

About Android Auto

Android Auto is designed to provide drivers with a more intuitive and safer way to use their Android devices while driving by minimizing distractions. It supports various apps from the Google Play Store, including Google Podcasts, Google Play Books, and third-party apps.

Integration between the Android device and the car's infotainment system is typically done through a USB connection, although wireless Android Auto is available in some vehicles, allowing for a connection without the need for a cable. The system's interface is familiar to Android users, with intuitive icons and Google's design language, making it straightforward and easy to use.

Many new vehicles come with Android Auto as a standard feature, and aftermarket systems are available for older cars. Compatibility and availability can vary by car model and country.

Disclaimer

The Elecbrakes app supports Android Auto to enhance safety and convenience while driving. Android Auto is designed to minimize distractions by displaying our app on your vehicle's built-in display with a simplified interface. To ensure safety, the app's functionality may be limited under Android Auto. We recommend completing any necessary setup on your Android device before starting your journey. Remember, interactions should occur using your vehicle's built-in controls and display. Let's keep the focus on the road and use technology responsibly.

GETTING STARTED



Please note - In accordance with Android auto guidelines, device management and initial setup of your brake controller must be done via the app. For the best experience we encourage you to take the time to tune your brake responses and multiple programs prior to using Android Auto.

To use Android Auto and integrate your Android device with your car for a safer and more convenient driving experience, ensure your vehicle has a compatible head unit. This feature is increasingly common in newer car models, but if your vehicle doesn't have it built-in, an aftermarket head unit that supports Android Auto can be an option.

Once your vehicle is confirmed to have Android Auto functionality, make sure you have both the latest version of the Android operating system on your device and the latest version of the Elecbrakes app. This ensures compatibility and access to the latest features.



After updating your Android device, connecting it to your car's head unit is the next step.

Each head unit has a unique process for establishing this connection, usually involving either a USB cable or a wireless connection. Consult your vehicle's owner's manual or the manufacturer's website for specific instructions tailored to your head unit model.

Once connected, Android Auto should automatically launch, giving you access to a range of applications and features such as navigation, music, phone calls, messaging, and now the Elecbrakes app, all designed for safe use while driving.

ANDROID AUTO OVERVIEW AND INITIAL CONNECTION

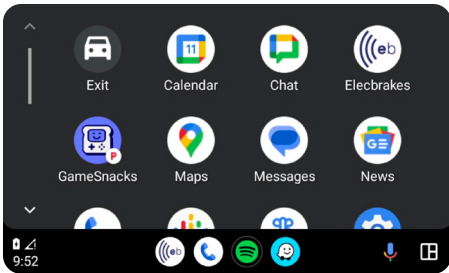

Getting started

Upon connecting your Android device to Android Auto, the Home screen displays compatible apps. If the Elecbrakes app or others aren't visible, navigate through the screens to find them.

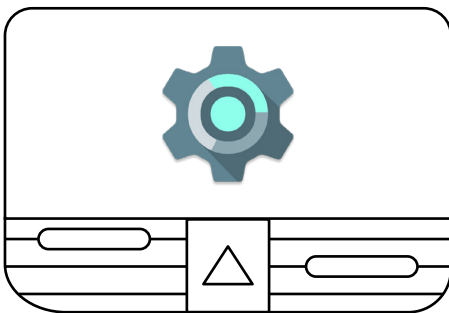

Verifying the App is Enabled for Android Auto:

Search Android Auto, select 'Customize launcher' to manage app visibility and order.

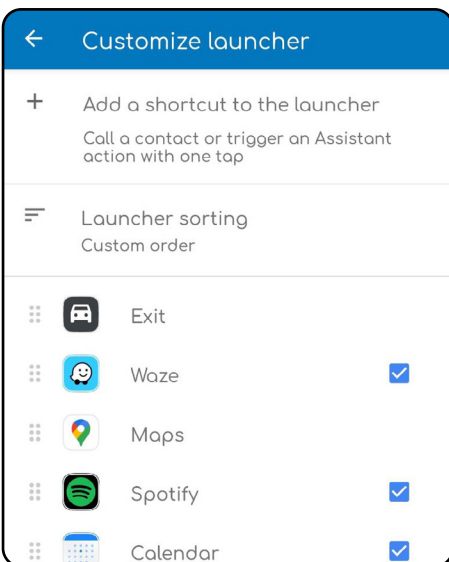

Vehicle-Specific Settings

Android Auto settings can differ between vehicles, designed to harmonize with each vehicle's unique controls and displays.

Exploring these settings can help tailor Android Auto to suit your driving habits and enhance your overall experience.



The Shortcut Bar

Android Auto's home screen includes a shortcut bar, populated with your most recently used apps for quick access. The Elecbrakes app will appear here if used recently.

USING ANDROID AUTO

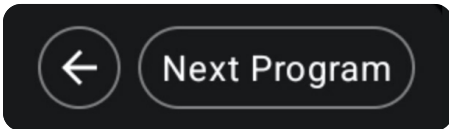

Program Selection

The banner at the top of the app screen indicates the active braking program. Use the 'Previous' and 'Next' buttons to cycle between your brake programs. These programs are presets that you can customize according to different towing needs or conditions. Refer to the [User Manual](#) for your Elecbrakes Brake Controller for more help with setting up programs.

Please note - You cannot edit program names within the Android Auto interface.

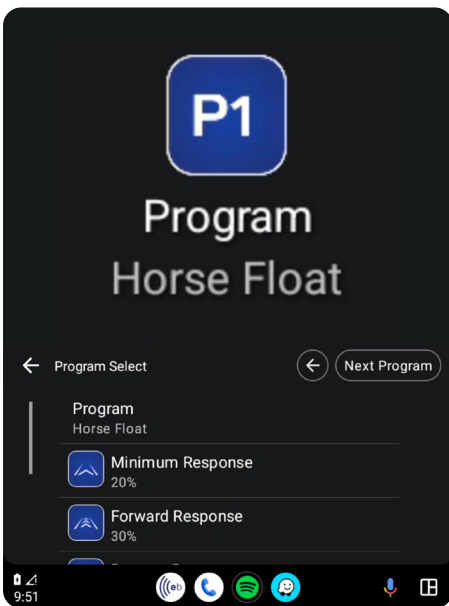

Program settings list view

When cycling between programs the Program icon (P1) will update to indicate the currently selected program.

Tapping on the program icon will open a list view, showing all the brake response settings for your current program.

By tapping 'Next program' you can also browse through the settings of your other programs in this list view to compare or adjust them as needed.

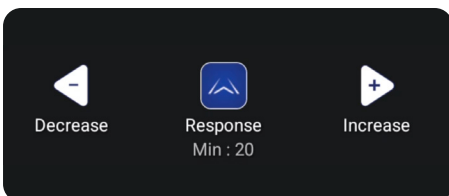

Response Setting and Adjustment

Adjustments of the brake response are made through the plus and minus buttons to the right and left of the blue brake response icon, which corresponds to the brake response mode you're currently editing. Simply tap this icon to cycle through the minimum, forward, reverse and override preset settings.

Please note - You cannot edit program names within the Android Auto interface.

USING ANDROID AUTO



Status indicator / Override button

The blue tick icon to the right serves as a confirmation of a successful Bluetooth connection.

During braking, the blue tick will change to a red circle, indicating a braking event. Tapping this circle at any time will activate the override function, engaging the override preset brake response to the trailer independent of the tow vehicle.

Simply tap again to disengage the override.

The override icon will take precedence over the brake indicator.

During an override, the app will automatically switch to the 'Override Preset' setting, allowing for convenient adjustment.

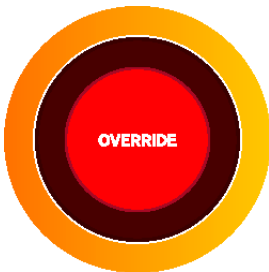
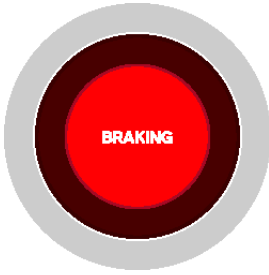

Please note - Android Auto does not support the feature where override can be held down to incrementally increase the override response. Adjustments to the override response must be done by using the "plus" or "minus" buttons.

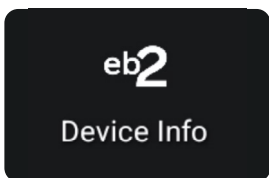

Device information

The device info button, in the bottom left, will display the currently connected device type. Tapping on this will present a list view of all your brake controller's specifications

Please note - Device management tasks must be completed through the Elecbrakes mobile app. Android Auto does not provide the functionality to pair a new device, change the device name, or select a different connected device. These actions must be done via your smartphone outside of Android Auto due to safety requirements and interface limitations.



NEED HELP?

Check out our FAQ page online
elecbrakes.com/FAQ



or call our customer service team on
1300 516 248